

MOUNTING HOLES
6 HOLES Ø8.15/8.05
EQUISPACED ON A 200.025 P.C.
MINIMUM C/BORE Ø17.00

NOTE A
RELEASE TRAVEL TO BE LIMITED
TO 5.50MM MAXIMUM BY MEANS
OF AN EXTERNAL STOP

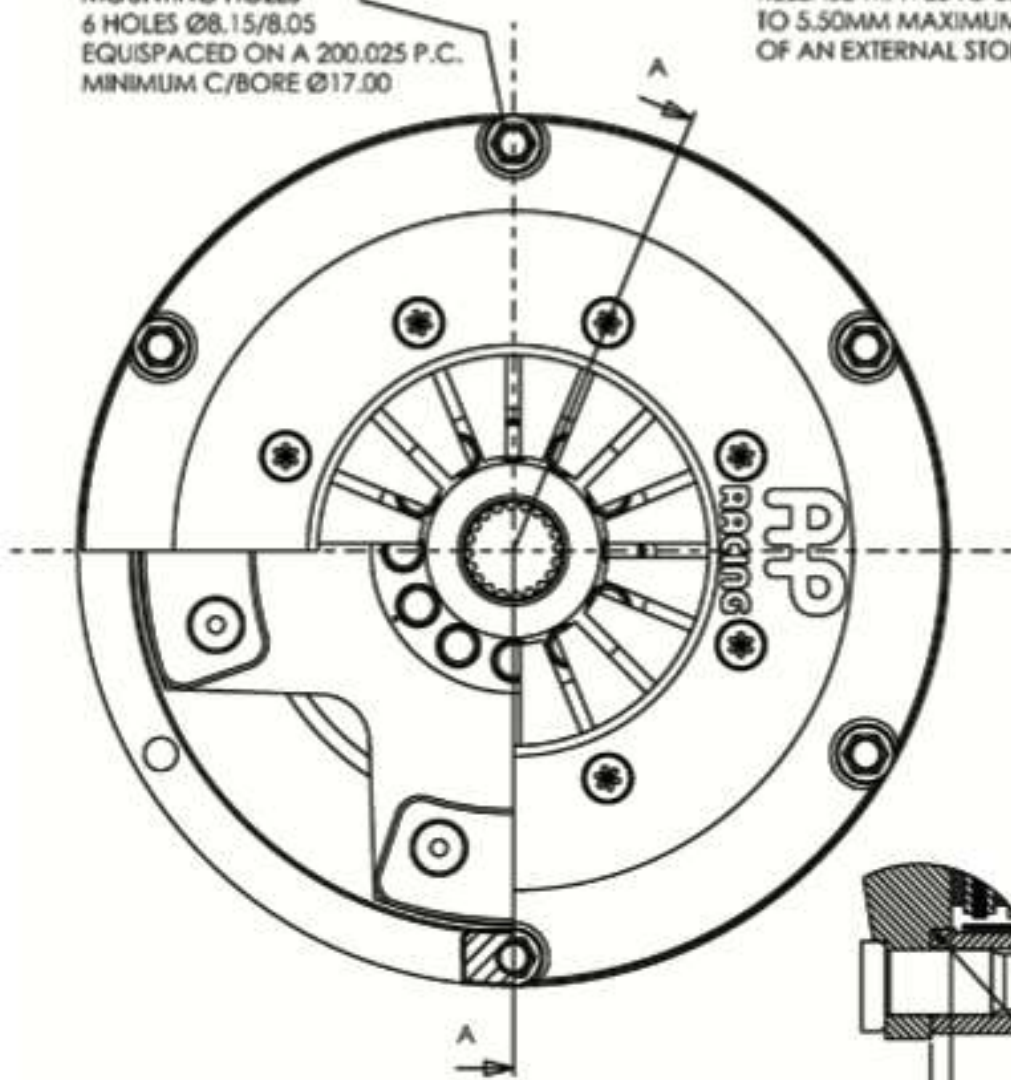

SET UP HEIGHT WORN
SSE SPECS ABOVE
(0.75MM WEAR IN)

SET UP HEIGHT NEW
SEE SPECS ABOVE

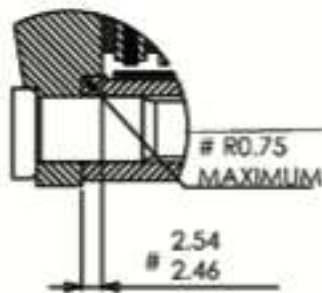
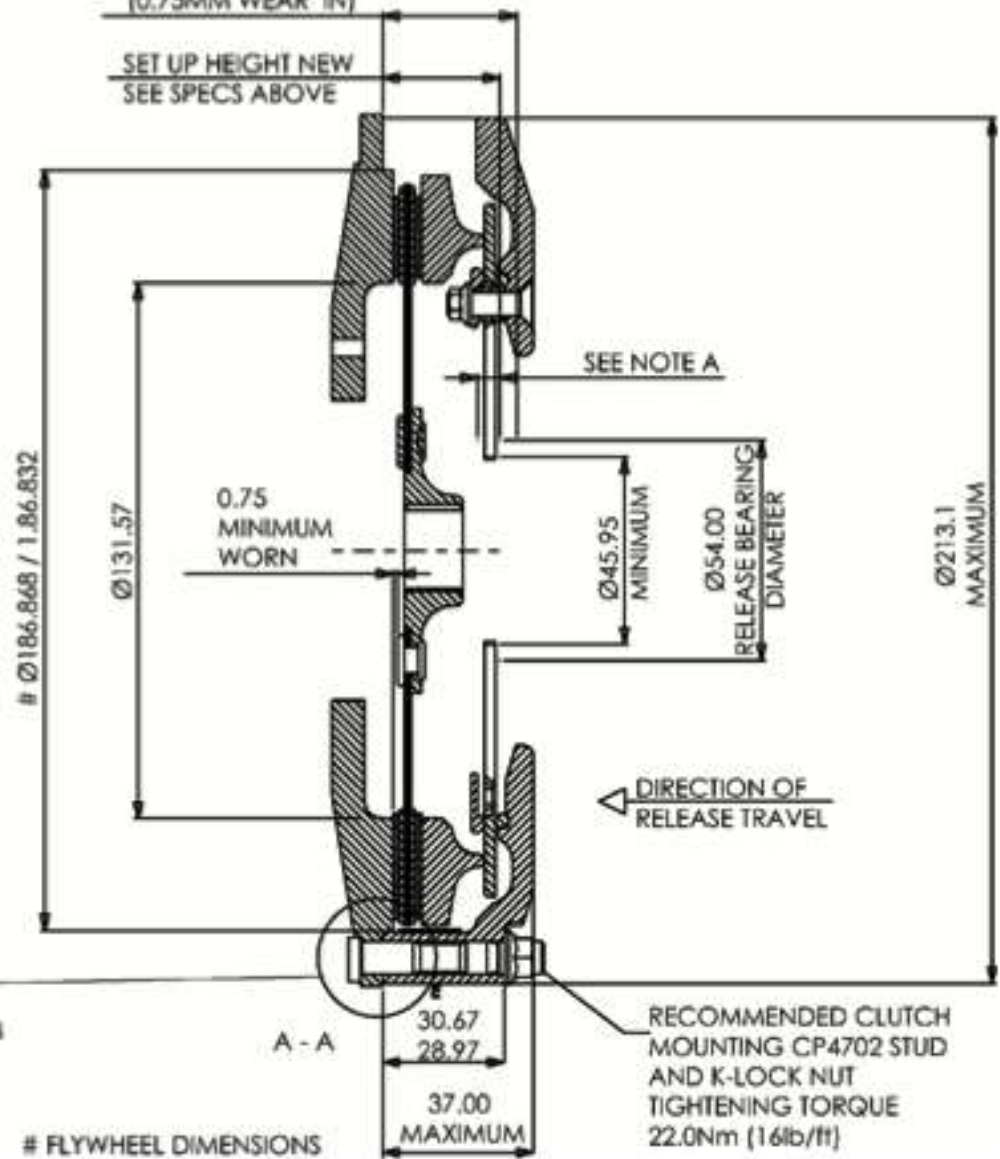

FLYWHEEL DIMENSIONS

RECOMMENDED CLUTCH
MOUNTING CP4702 STUD
AND K-LOCK NUT
TIGHTENING TORQUE
22.0Nm (16lb/ft)